

Specifications

- Voltage rating: 100V AC, DC
- Current Rating: 2A, AC, DC
- Withstand voltage: 800V AC/minute
- Contact resistance: 10m Ω max
- Insulation resistance: 1000m Ω min
- Temperature range: -25°C ~ +85°C
- Compliant with RoHS and REACH
- Contact JVT for details

Standards



Assembly layout

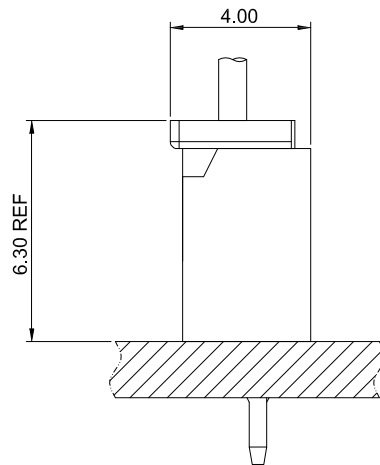

JVT CONNECTORS
TEL: +86-0769-39015968/81608536
FAX: +86-0769-8535 8632
Http://www.jvt.ltd

JVT2065H

2.0mm Pitch housing

HOUSING

Part No.: JVT3025HNO-2*XXXX-ZH

Material: Nylon 66 UL94V-0

Mates With Part(s): JVT3024 Terminal

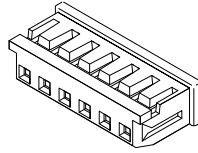
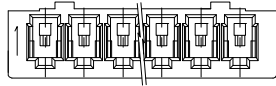

JVT2065HNO-XX
logo
系列码
胶壳
PIN数
PA66 UL94V-0

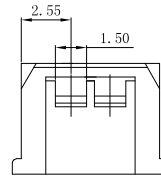
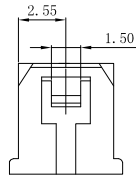
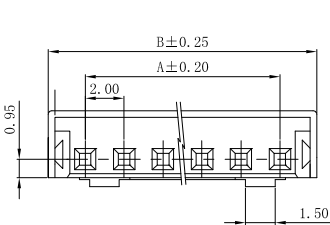
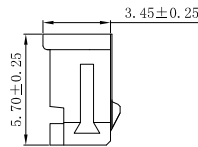
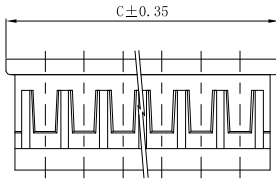

02P

03P

| PIN | DIM. (mm) | | |
|-----|-----------|-------|-------|
| | A | B | C |
| 02 | 2.00 | 5.10 | 5.80 |
| 03 | 4.00 | 7.10 | 7.80 |
| 04 | 6.00 | 9.10 | 9.80 |
| 05 | 8.00 | 11.10 | 11.80 |
| 06 | 10.00 | 13.10 | 13.80 |
| 07 | 12.00 | 15.10 | 15.80 |
| 08 | 14.00 | 17.10 | 17.80 |
| 09 | 16.00 | 19.10 | 19.80 |
| 10 | 18.00 | 21.10 | 21.80 |
| 11 | 20.00 | 23.10 | 23.80 |
| 12 | 22.00 | 25.10 | 25.80 |
| 13 | 24.00 | 27.10 | 27.80 |
| 14 | 26.00 | 29.10 | 29.80 |
| 15 | 28.00 | 31.10 | 31.80 |

JVT2065T

2.0mm Pitch Crimp Terminal

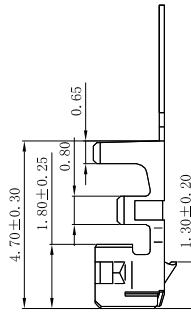
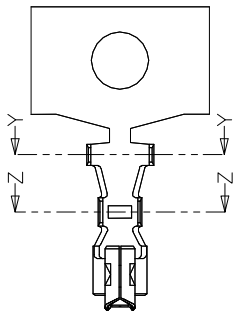

JVT2065TP-SNX
logo
系列码
端子
磷铜
S-先冲后镀
E-先镀后冲
SN-镀锡

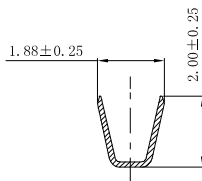

SECTION Y-Y

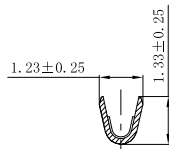

SECTION Z-Z

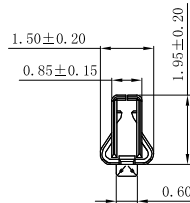

| | | | | | |
|---------------|-------------|-------------|------------|-----------------|--------------------|
| JVT2065TP-SNX | Phos Bronze | Tin Plated | AWG#24-30 | 1.3mm(Max) | JVT2065 HOUSING |
| PART NO | Material | Finish(Pin) | Wire Range | Insulation O.D. | Mates With Part(s) |

JVT2065W

2.0mm Pitch Wafer-DIP TYPE

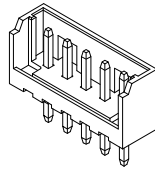
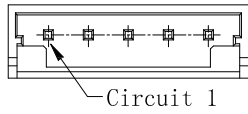

JVT2065WN0-XXSNK-D
 Logo 系列码 针座
 N0-PA66 UL94V-0
 DIP
 K-打K脚
 SN-镀锡
 PIN数

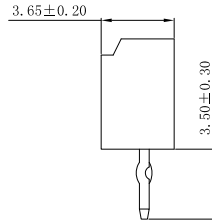
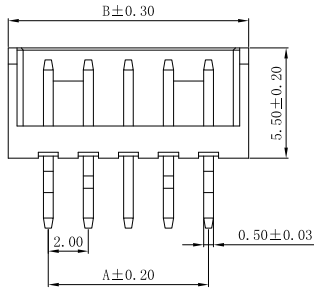

PCB LAYOUT

| PART NO. | Dimensions (mm) | |
|----------|-----------------|-------|
| | A | B |
| 02 | 2.00 | 6.00 |
| 03 | 4.00 | 8.00 |
| 04 | 6.00 | 10.00 |
| 05 | 8.00 | 12.00 |
| 06 | 10.00 | 14.00 |
| 07 | 12.00 | 16.00 |
| 08 | 14.00 | 18.00 |
| 09 | 16.00 | 20.00 |
| 10 | 18.00 | 22.00 |
| 11 | 20.00 | 24.00 |
| 12 | 22.00 | 26.00 |
| 13 | 24.00 | 28.00 |
| 14 | 26.00 | 30.00 |
| 15 | 28.00 | 32.00 |

| | | | | |
|--------------------|--------------|---------------|-------------|--------------------|
| JVT2065WN0-XXSNK-D | PA66 UL94V-0 | Brass | Tin Plated | JVT2065 Housing |
| PART N0 | Material | Material(Pin) | Finish(Pin) | Mates With Part(s) |